

■ 构造图 Construction(mm)

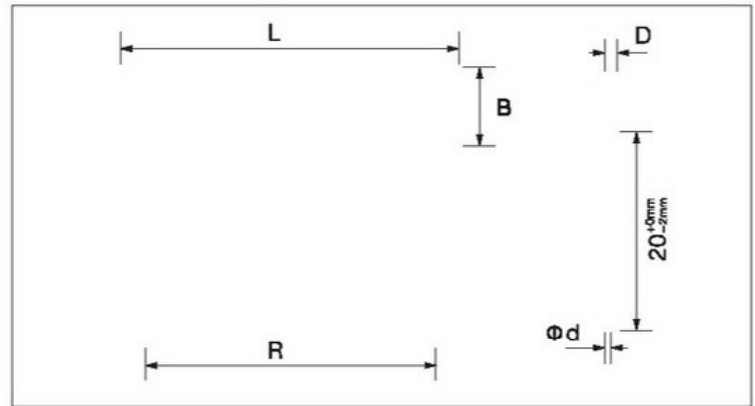

■ 产品特点 Features

- 厚膜高阻电阻
- 引线间距可变
- 阻值能达到1TΩ
- 极好的阻值精度、温度系数和电压系数
- 未刻值能经受更高的工作电压
- High value thick film resistors
- Variable lead span
- Resistance values up to 1 Teraohm
- Excellent values of tolerance, TCR and VCR
- Untrimmed for higher Working Voltage

■ 外形尺寸 Dimensions(mm)

| 尺寸(size) | L | B | D | R | d |
|----------|------|-----|-----|-----|-----------------------|
| 1210 | 3.2 | 2.5 | 0.9 | 2.0 | 0.40 ^{±0.05} |
| 25 | 3.8 | 5.0 | 1.0 | 2.5 | 0.40 ^{±0.05} |
| 2512 | 6.3 | 3.5 | 1.0 | 5.5 | 0.40 ^{±0.05} |
| 4020 | 10.2 | 5.1 | 1.0 | 9.5 | 0.40 ^{±0.05} |

L=长度, B=宽度, D=厚度, C=包围电极宽度(mm)

L=Length, B=Width, D=Thickness,

C=Width of wraparound (in mm)

■ 应用范围 Applications

- 各种电子设备
- all kinds of electrical equipments

■ 执行标准 Reference Standards

Q/DRT006-2009

■ 降功耗曲线 Derating Curve

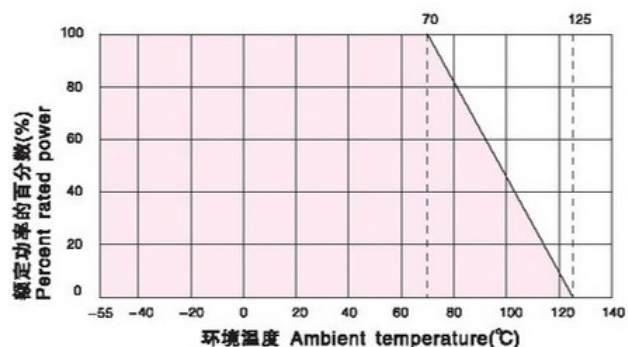

■ 技术说明 Technical Specifications

| 型号 Type | 额定功率 P_n (W) Rating Power P_n (W) | 工作电压(V) Working Voltage (V) | | 阻值范围/精度/温度系数 ¹⁾ /电压系数 ²⁾ Resistance Range/Tolerance/TCR ¹⁾ /VCR ²⁾ | | | | | |
|------------|--|--------------------------------|------------------|---|---|---|---------------------------------------|---|---|
| | | 刻槽 Timmed | 未刻槽 Untrimmed | 1M-100M | >100M-500M | >500M-1G | >1G-10G | >10G-100G | >100G-1T |
| 1210 | 0.5 | 300 | 1000 | 1/2/5/10% TC25/50/100 <50ppm/V | 2/5/10/20% TC50/100/250 <100ppm/V | 5/10/20% TC100/250 <100ppm/V | 5/10/20/30% TC250/500 <500ppm/V | 5/10/20/30% TC500/1000 <1000ppm/V | - |
| 25 | 0.7 | 300 | 500 | 2/5/20% TC50/100 <50ppm/V | 5/10/20% TC100/250 <100ppm/V | 5/10/20% TC100/250 <100ppm/V | 10/20/30% TC250/500 <500ppm/V | 10/20/30% TC500/1000 <1000ppm/V | - |
| 2512 | 1.0 | 1200 | 2500 | 1/.../10% TC25/50/100 <10ppm/V | 1/2/5/10/20% TC25/50/100 <25ppm/V | 1/2/5/10/20% TC100/250 <25ppm/V | 2/5/10/20% TC100/250 <100ppm/V | 5/10/20/30% TC250/500 <250ppm/V | 10/20/30/50% TC500/1000 <500ppm/V |
| 4020 | 2.0 | 4000 | 6000 | 1/.../10% TC25/50/100 <5ppm/V | 1/2/5/10/20% TC25/50/100 <10ppm/V | 1/2/5/10/20% TC25/50/100 <10ppm/V | 2/5/10/20% TC50/100 <25ppm/V | 5/10/20/30% TC100/250 <100ppm/V | 5/10/20/30% TC250/500 <250ppm/V |

注: 1) 温度系数25/50: 温度范围+25°C~+85°C

1) TCR25/50: Temperature range+25°C~+85°C

2) 电压系数在10V和100V之间测量

2) VCR measured between 10V and 100V

更好的精度、温度系数和电压系数及其他外形尺寸或电压分压器可按要求和协议提供

Closed values of tolerance, TCR and VCR, other dimensions or voltage dividers on request and agreement

■ 性能指标 Performance

| 试验项目 Test Item | 性能要求 Specifications | | | 试验方法 Test Methods |
|-----------------------------|---------------------|--------|------|---------------------|
| 长期稳定性 Long term stability | ≤1G | 1G~10G | >10G | / |
| 高温贮存 High temperature store | <1% | <2% | <5% | 125°C, 1000h |
| 寿命 Load life | <0.5% | <1% | <2% | 70°C, P_n , 1000h |

■ 订货示例 How To Order

例如 Example

| | | | | | | |
|--------------|----------------|----------------------|-----------------------|---|---|-------------------|
| HVR | 30 | 1.0W | 100MΩ | ±0.25% | ±100(10 ⁻⁶ /K) | 盒装 |
| 产品型号 Type | 类型 Style | 功率 Power | 标称阻值 Nominal Value | 精度 Tolerance | 温度系数 TCR | 包装方式 Packaging |
| HVR | 30 40 50 | 1.0W 1.2W 3.0W | 100MΩ | ±0.25% ±1% ±2% ±5% ±10% ±20% ±30% | ±25(10 ⁻⁶ /K) ±50(10 ⁻⁶ /K) ±100(10 ⁻⁶ /K) ±250(10 ⁻⁶ /K) ±500(10 ⁻⁶ /K) ±1000(10 ⁻⁶ /K) | 盒装 box 袋装 bag |

包装说明: 包装塑料自封袋包装(起订量30只)。

Packaging: Plastic recloseable bags (moq: 30PCS)